

10' x 30' Plan (300 SQ FT)

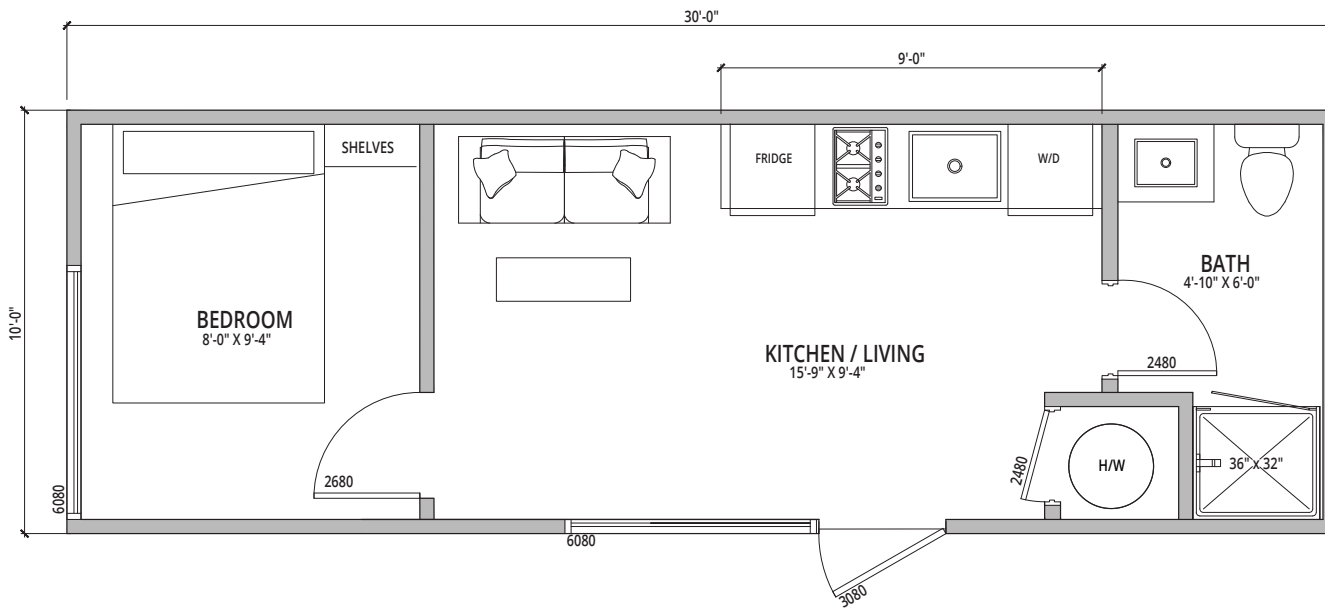

STANDARD FEATURES

- CLT construction
- High efficient European tilt and turn windows
- Environmentally friendly exterior insulation to meet R22 effective
- Cedar cladding incl. rain screen
- Built to BC building code
- LED lighting
- Electric heat
- Electric hot water tank
- Kitchen
- Metal awning above entry door

OPTIONS:

- Air conditioning
- Powered/manual blinds
- Multi media (audio/video)
- Smart home options (lighting/ audio/security/heating control)
- Appliances
- Composting toilet
- Green roof
- Custom metal awnings
- Deck
- Security system/cameras

OFF GRID OPTIONS

- Full solar solution
- Wood stove
- Propane stove
- Composting toilet
- Roof water collection
- Generator ready